

ASR 44 - ASR SELF HOLD THERMAL CUTOUT

Electrical scheme

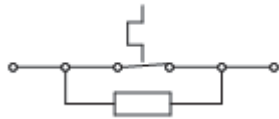

<u>Contact</u>	<u>SPST; normally closed</u>
<u>Rated voltage</u>	<u>115V AC; 230V AC; 24V AC,DC; 48V AC,DC</u>
<u>Rated current</u>	
<u>of resistance loading $I_{zn}, \cos\alpha = 1,0$</u>	<u>16 A</u>
<u>Number of switching cycles at rating loading</u>	<u>6 000 cycles</u>
<u>Range of rated switching temperatures</u>	<u>65 °C – 175 °C</u>
<u>Switching temperature tolerance</u>	<u>±5 K/ ±7,5 K/ ±10 K</u>
<u>Temperature limit above which automatic reset shall not occur</u>	<u>not higher than: - 20°C</u>
<u>Speed of temperature changes to determine switching temperature</u>	<u>0,5 ÷ 1 K / m</u>
<u>Thermal resistance</u>	<u>max 260 °C / 1min</u>
<u>Degree of protection</u>	<u>IP 00</u>
<u>PTI of material used for insulation</u>	<u>250 V</u>
<u>Electrical strength of insulation</u>	<u>2 500 V</u>
<u>Construction</u>	<u>incorporated; non-electronic</u>

Order sample: ASR44 90.05 A1 W1 230V

(Type - Switching temperature - Switching temperature tolerance - Base for mounting - Connectors orientation* - Rated voltage)

* Connectors orientation:

- W1: with straight lead 0°
- W2: with deflect lead 30°
- W3: with deflect lead 90°



Phone: 330-966-3796
Fax: 330-408-7085
sales@calcoelectric.com
2381 Locust St. S., Unit #6
Canal Fulton OH, 44614
www.calcoelectric.com

ASR44 - ASR SELF HOLD THERMAL CUTOUT

3/4" DISC SELF HOLD THERMAL CUT OUT

The self hold thermal cut out is designed to prevent overheat or fault conditions in a heater. Once activated in a fault condition, the contacts open and remain open. The only way to reset is to remove power from the circuit. This design feature adds extra safety over an automatic reset device and works much like a manual reset, but without the push button and without the problem of remote access to reset the device manually.



HOW THE SELF HOLD ASR WORKS

The ASR is a thermostat/resistor combination. The resistor is electrically located below the contact arm of the thermostat. When the thermostat contacts open at the predetermined trip temperature, the resistors are in series with the load. The resistors maintain a temperature to the temperature sensitive bimetal of the thermostat to maintain the contacts in the open state.



To reset the self hold ASR, power must be removed and sufficient time to allow for the self hold ASR bimetal to cool down before the thermostat resets itself to the normally closed position.

FEATURES

- *Recognized UL component, tested to UL standard 873
- *Available with surface, air sensing, well or cavity type mountings
- *High switching current 25 AMP/240 volts
- *Reliable temperature performance over the life of the device
- *Ultimate safety device in critical applications
- *Also available for 115VAC, 24VAC/DC, 48VAC/DC, applications
- *Various mounting configurations along with different terminations available

APPLICATIONS

Unit Heaters
Boilers and Steam Generators
Circulation Heaters
Air Conditioners
Hand Dryers

Process Air Heaters
Large Tank Heaters
Spa Heaters
Ventilating Equipment
Tabletop Appliance

Comfort Air Heaters
Immersion Heaters
Sauna Heaters
Vending Machine
Commercial Cooking Equipment



Phone: 330-966-3796
Fax: 330-408-7085
sales@calcoelectric.com
2381 Locust St. S., Unit #6
Canal Fulton OH, 44614
www.calcoelectric.com

ASR 44 - ASR SELF HOLD THERMAL CUTOUT

Standard Construction

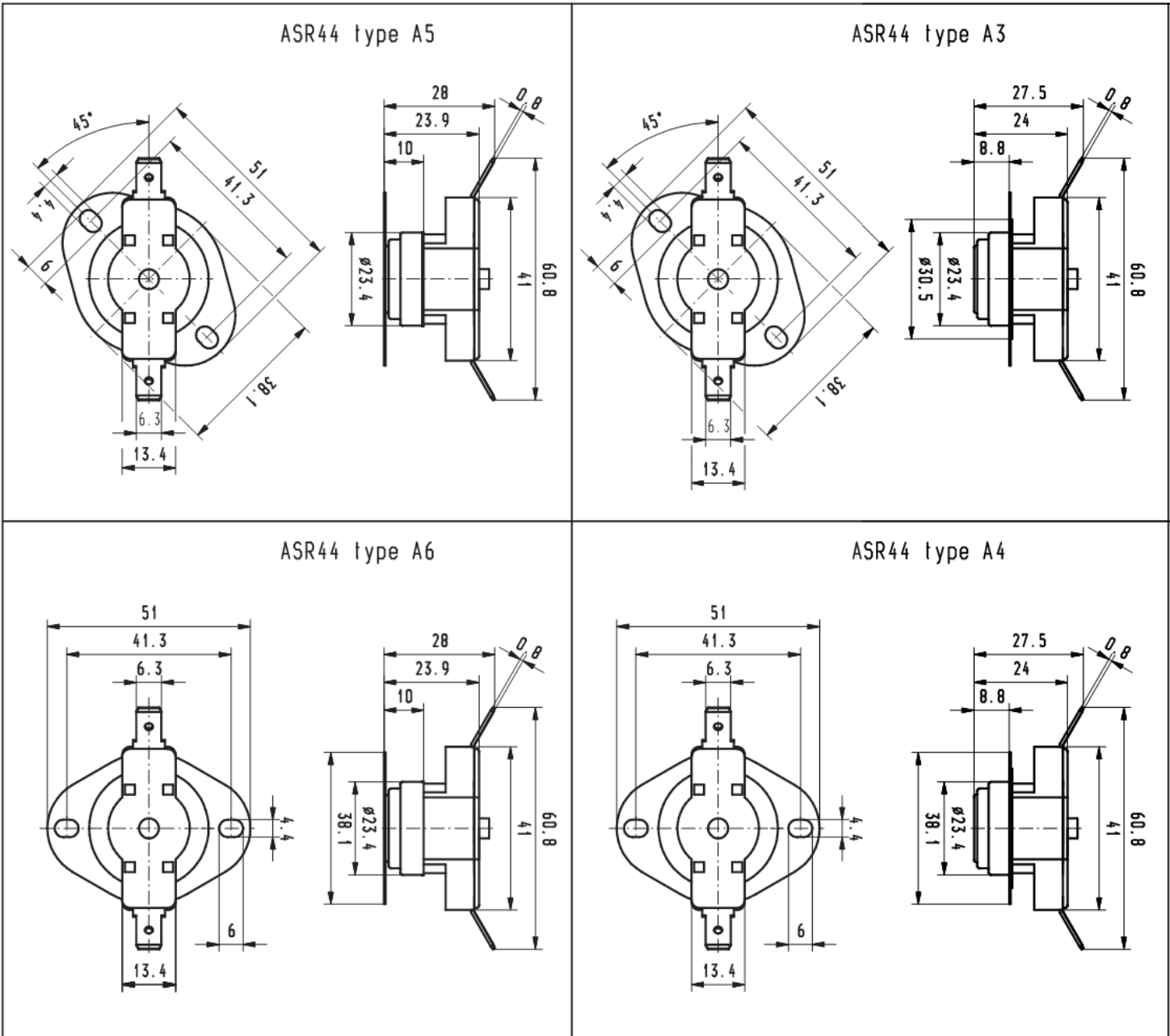

Phone: 330-966-3796
Fax: 330-408-7085
sales@calcoelectric.com
2381 Locust St. S., Unit #6
Canal Fulton OH, 44614
www.calcoelectric.com

ASR 44 - ASR SELF HOLD THERMAL CUTOUT

Standard Construction (Page 2)

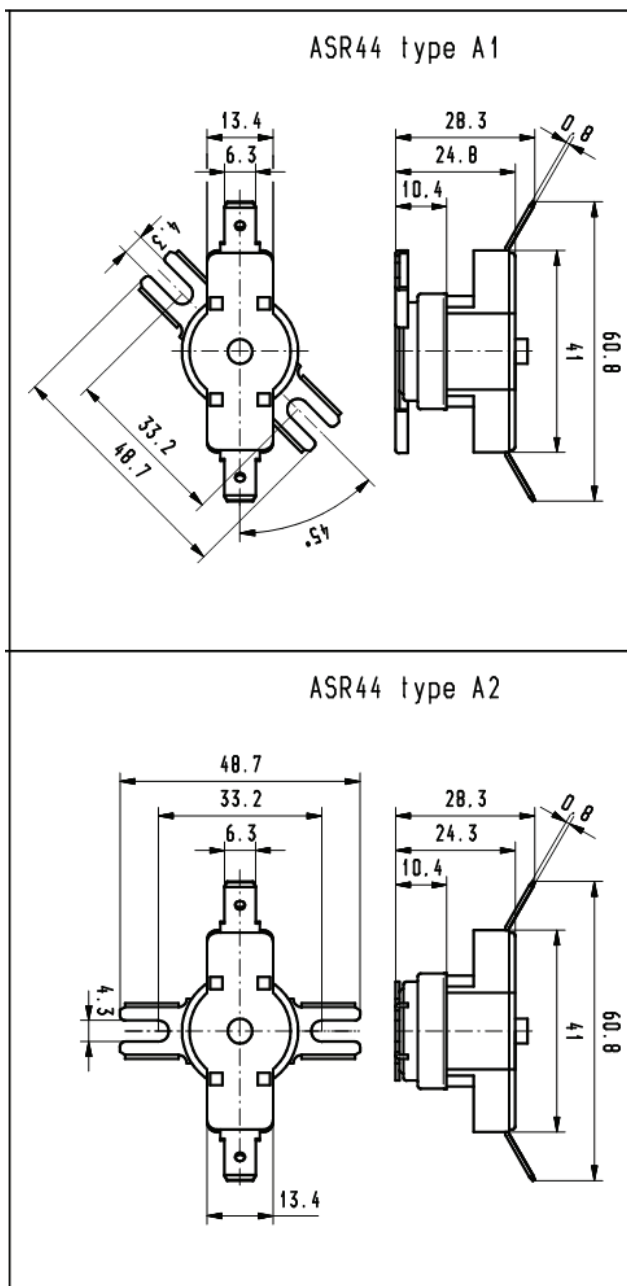

Phone: 330-966-3796
Fax: 330-408-7085
sales@calcoelectric.com
2381 Locust St. S., Unit #6
Canal Fulton OH, 44614
www.calcoelectric.com